

Media Number : 000037-24C

Issue Date: 8/30/2024

Model And Serial Number(s):

ND18L, NR23L

Subject:

Lift Link Telematics Installation

Cause:

New Lift Link Telematics solution being provided for current model trucks.

Resolution:

Providing installation instructions for field install of Lift Link Telematics.



WARNING

- Do not operate a lift truck unless you are qualified and authorized and have read and understand the Operation and Maintenance Manual (OMM) or Operating Instructions (BL).
- Do not perform service or repair on lift trucks unless you are qualified and authorized and have read and understand the Service Manual or Service Handbook (SH) and any applicable safety guidelines prior to working on equipment.
- Improper operation, service, or repair could result in injury or death.
- Make all repairs with the lift truck parked on a level, hard surface. Block the lift truck to prevent rolling while working on, or under, the lift truck. Use a tire cage if tires are to be replaced or worked on.
- Ensure enforcement of company policy for proper LOCKOUT/TAGOUT procedure. (Please refer to HPK article 000019-15 for general guidelines)
- Disconnect battery prior to working on any electrical components or welding.
- Obey all safety guidelines when welding on or near flammable fluids. Always have an approved fire extinguisher on hand.

Lift Link Telematics Installation

Logisnext



This document contains information to assist with scheduled or as-needed product service.
Always refer to all Safety and Cautionary Instructions and Warnings in the applicable Service Manual and Operation and Maintenance Manual.

Lift Link Telematics Installation

Logisnext

Step 1: Make sure you have all the required components (included in kit part number **W0001-RK087**).



Relay Harness
51853948



Telematics Harness
W0001-RK006

Lift Link Telematics Installation

Logisnext

Step 1 cont:



Telematics Display
24058-KT010



Impact Sensor
26820-KT010



Band Clip x4
0531800410

Lift Link Telematics Installation

Logisnext

Step 1 cont:



VAC4 Ram Mount Kit
69973-KT005



Hex Nut x6
F230003000



Washer x12
F250003000



Screw x6
0584700310

Lift Link Telematics Installation

Logisnext

Step 1 cont:

Relay Mounting Bracket
51927776



Screw x2
F121006012

Logisnext

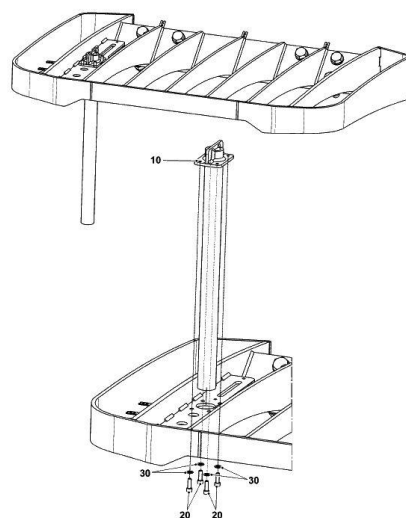
[illegible]

This document contains information to assist with scheduled or as-needed product service.
Always refer to all Safety and Cautionary Instructions and Warnings in the applicable Service Manual and Operation and Maintenance Manual.

Lift Link Telematics Installation

Logisnext

Step 2: Disconnect the battery, then remove the top dash cover/armrest.



Be careful of the harnesses going to switches on dash panel, these can be disconnected in order to remove the panel completely.

Lift Link Telematics Installation

Logisnext

Step 3: Install the relay mounting bracket to the front of the controller compartment as shown, then install the relays of the relay harness.



This document contains information to assist with scheduled or as-needed product service.
Always refer to all Safety and Cautionary Instructions and Warnings in the applicable Service Manual and Operation and Maintenance Manual.

Lift Link Telematics Installation

Logisnext

Step 4: Connect the relay harness XS905 to XB905 on the truck, then secure any excess harness with a cable tie.

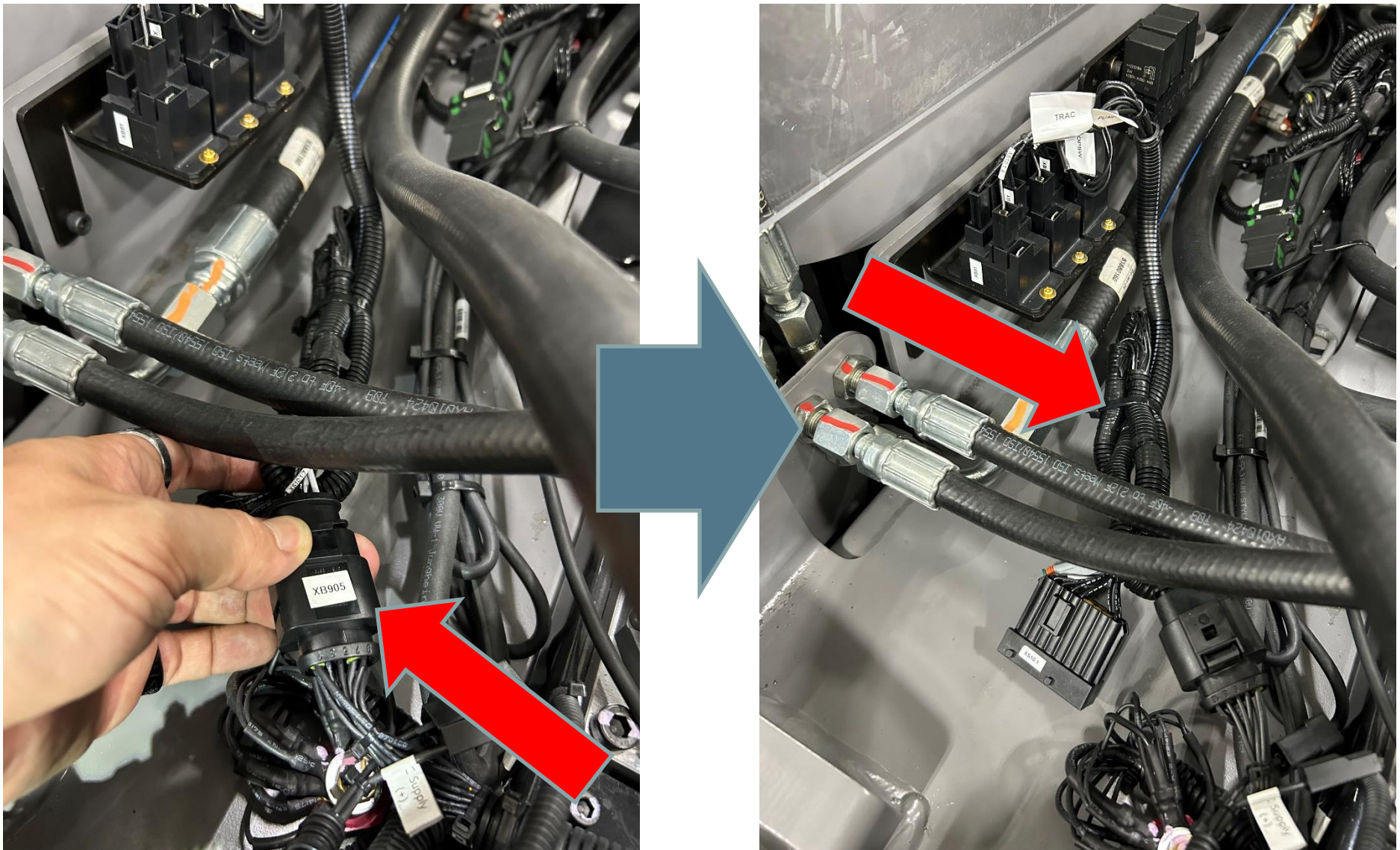

This document contains information to assist with scheduled or as-needed product service.
Always refer to all Safety and Cautionary Instructions and Warnings in the applicable Service Manual and Operation and Maintenance Manual.

Lift Link Telematics Installation

Logisnext

Step 5: Install impact sensor to the frame as shown.

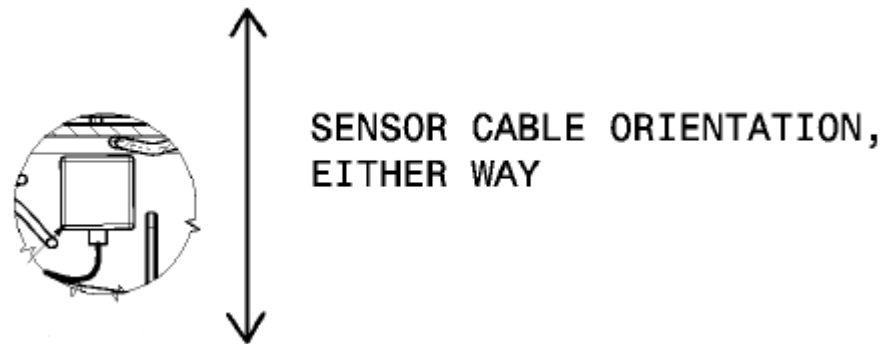
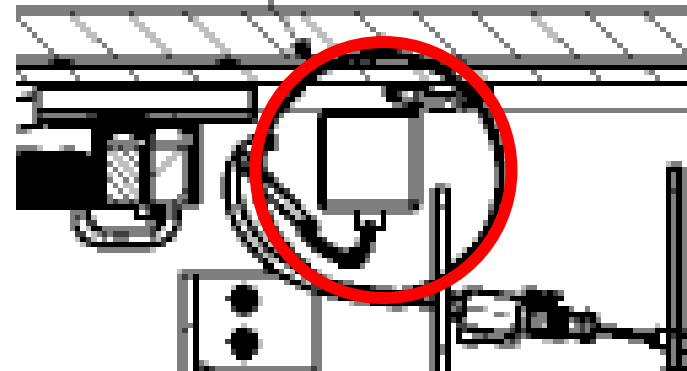
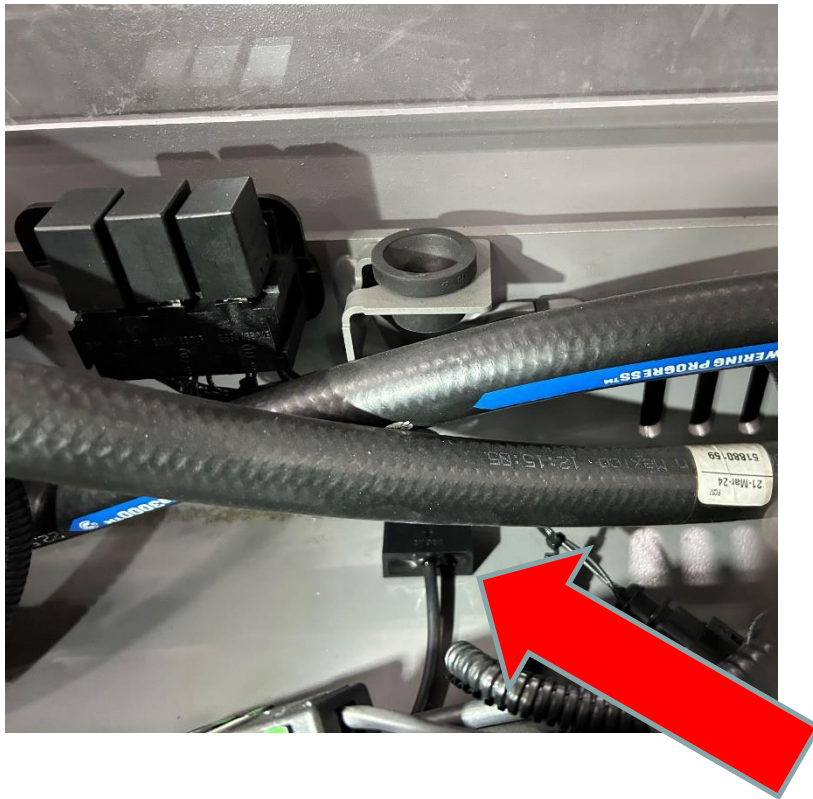

Lift Link Telematics Installation

Logisnext

Step 6: Connect the telematics harness to the relay harness, then route up the LH secondary lift cylinder with impact sensor harness.

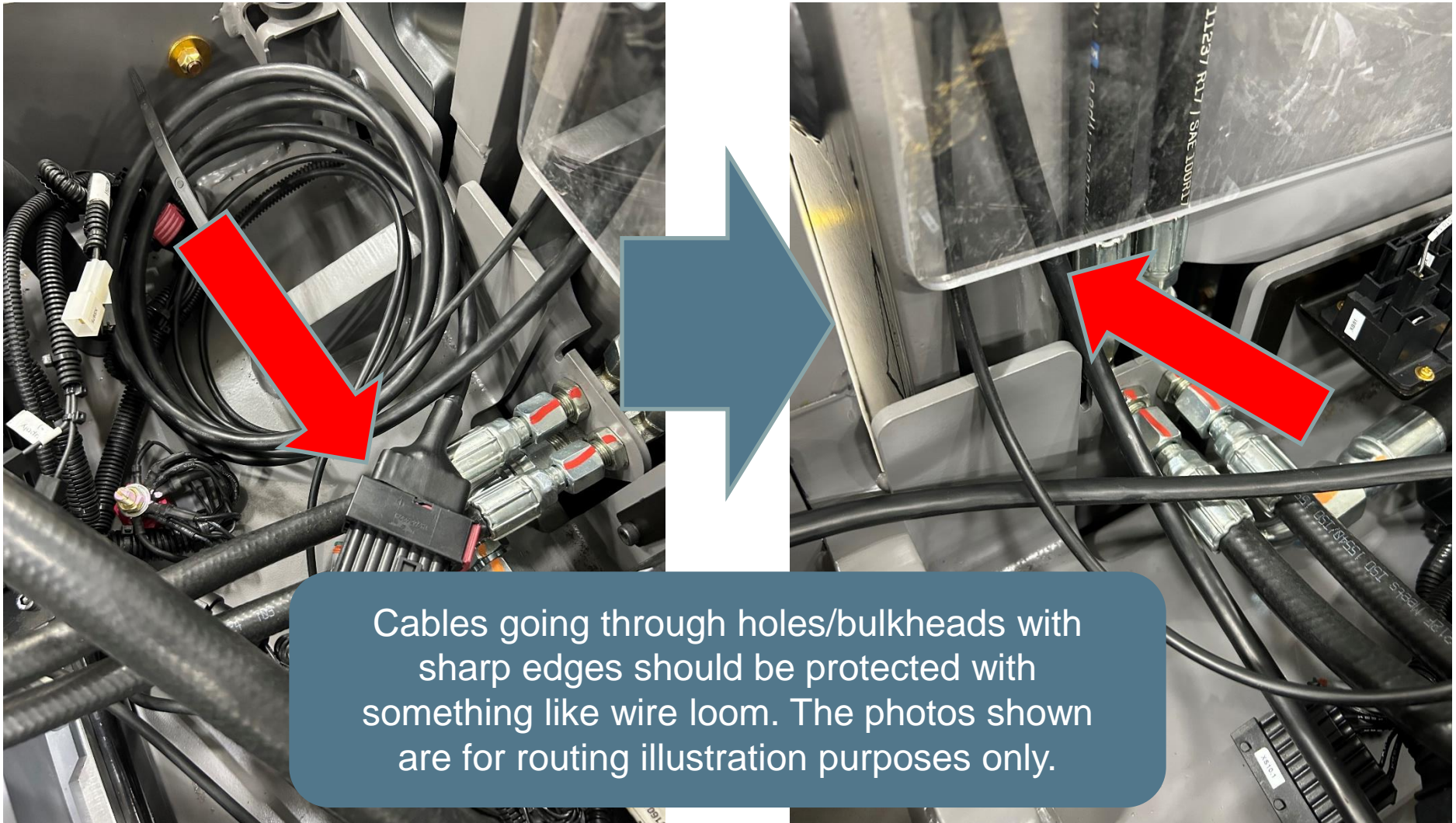

Lift Link Telematics Installation

Logisnext

Step 7: Route both harnesses up along secondary lift cylinder and secure with cable ties.



Lift Link Telematics Installation

Logisnext

Step 8: Route harnesses out over the OHG and secure to cable tie mounting locations.

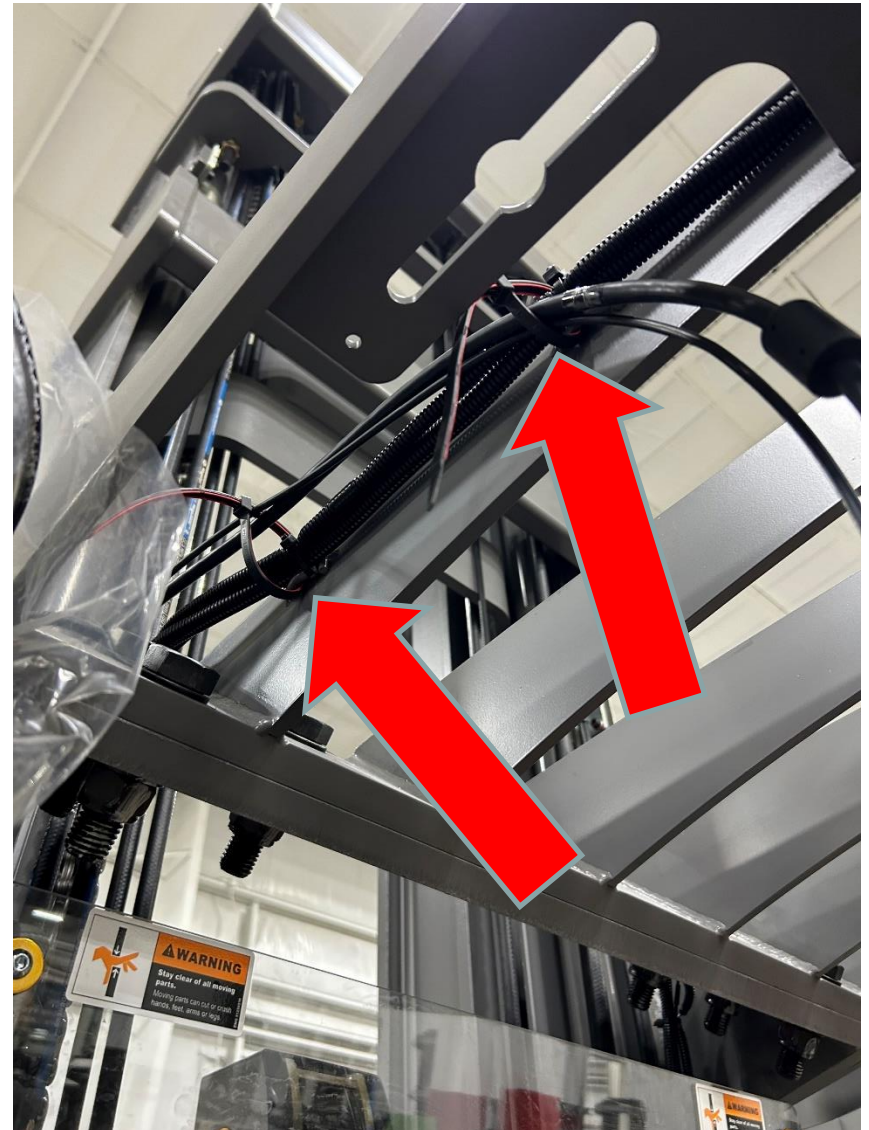

Lift Link Telematics Installation

Logisnext

Step 9: Install VAC mount to the option bracket and route both harnesses through the opening.



Lift Link Telematics Installation

Logisnext

Step 10: Connect both harnesses to VAC unit, then mount to the bracket.

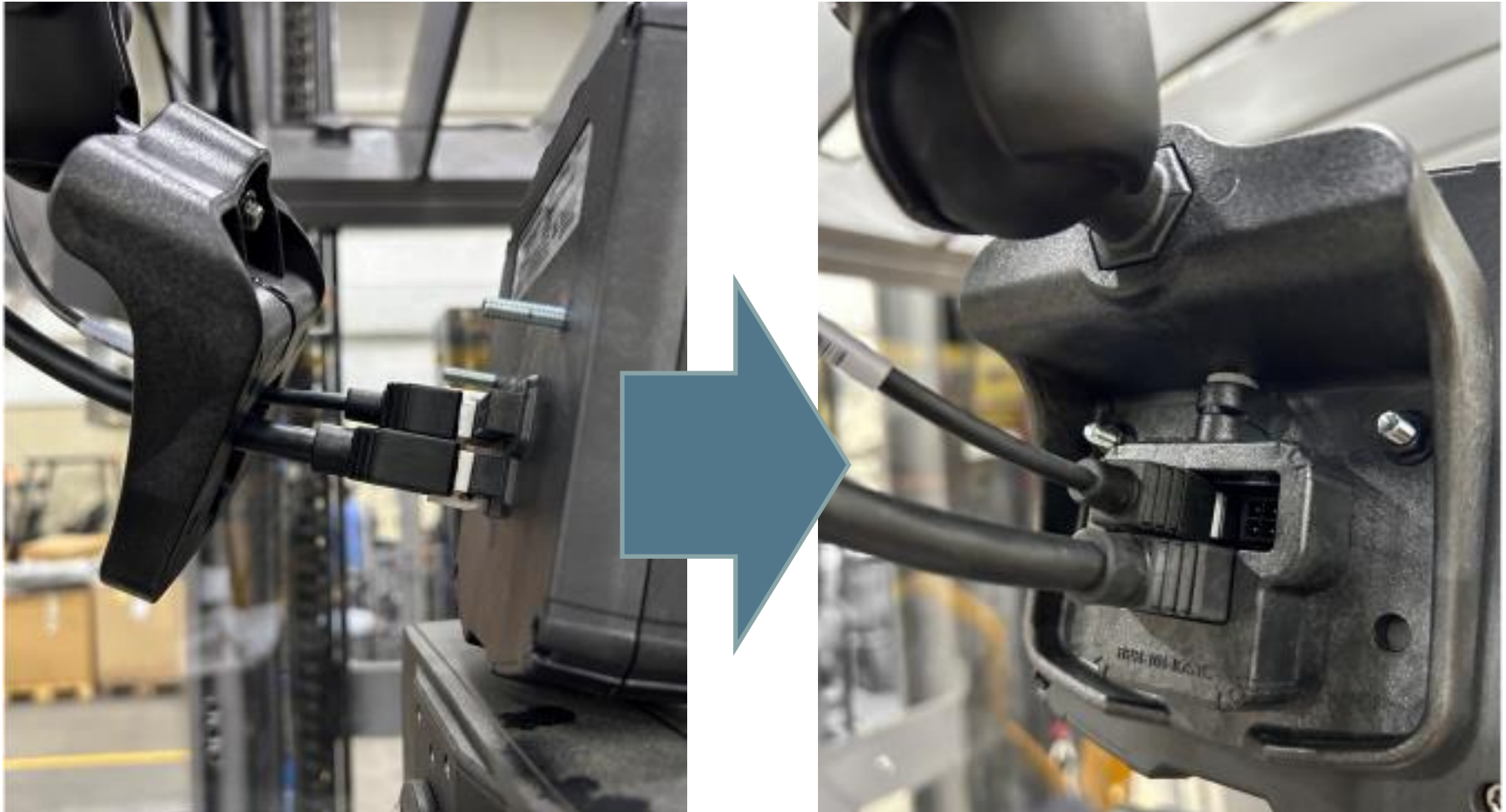

Lift Link Telematics Installation

Logisnext

Step 11: Secure any excess harness out of the way in the controller compartment with a cable tie.

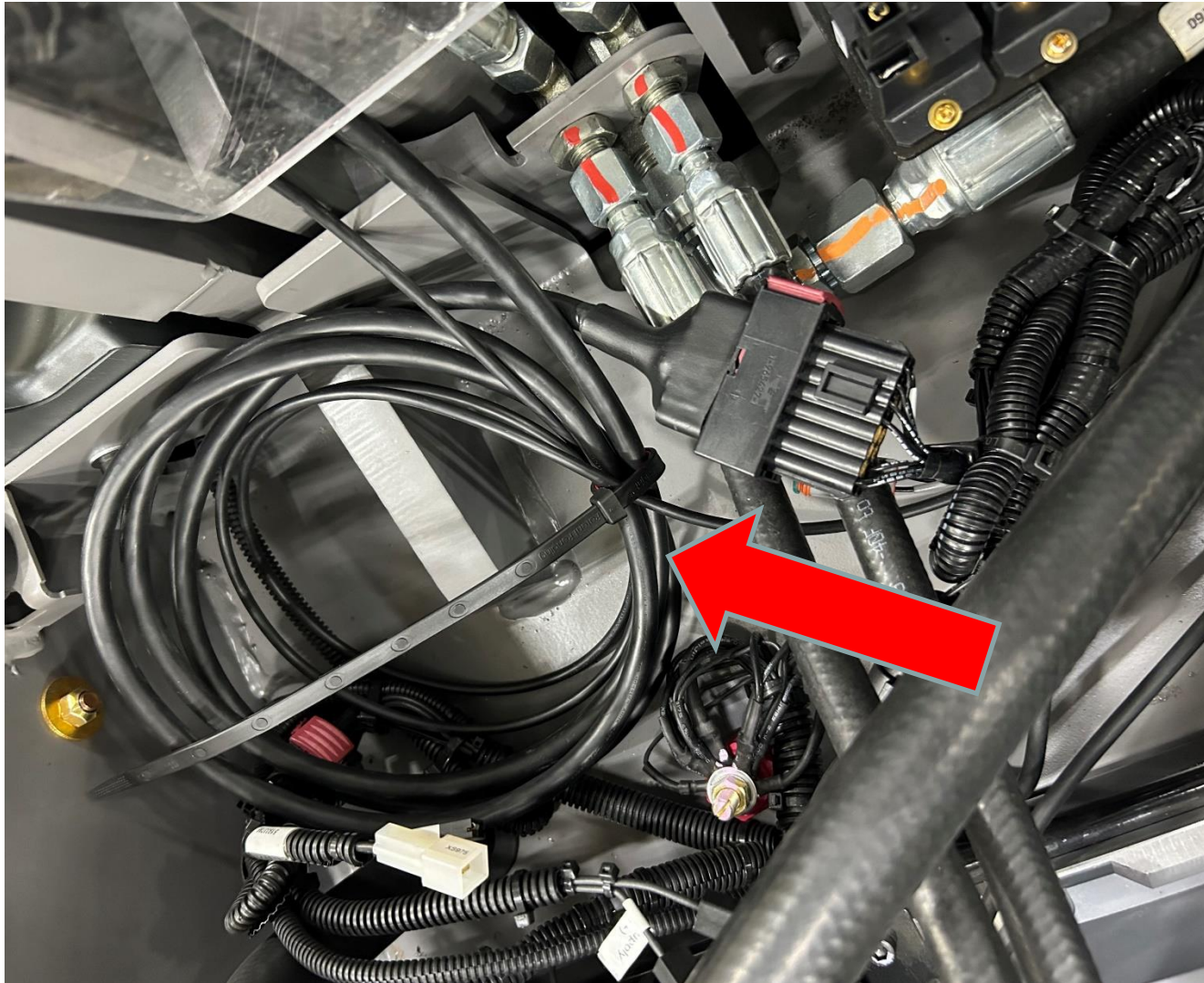

Lift Link Telematics Installation

Logisnext

Step 12: Replace the dash panel on the truck.



Make sure to reconnect any dash panel switches that were previously disconnected.

Lift Link Telematics Installation

Logisnext

Step 13: Connect the battery and power on the truck to verify the VAC unit is powered.

Don't worry about any errors that come up, as the setup hasn't been done yet.



Lift Link Telematics Installation

Logisnext

Step 14: Perform the validation steps as shown in the following slides.



Begin by unplugging the access control plug on the harness. The truck should now NOT travel until logged in.



1. Press 2 on the keypad to select "Config" and then press the green ENTER button.

It is recommended to have the vehicle's drive wheel(s) elevated prior to starting verification unless there is sufficient space to drive *slowly* in forward and reverse for up to 15 seconds at a time.



2. Use the keypad to enter **7262468** and then press the green ENTER button.



3. Use the keypad to enter **2378** and then press the green ENTER button.
(Note: truck able to run once this step is complete).

Lift Link Telematics Installation

Logisnext



4. Press 6 on the keypad to select “**Hardware**” and then press the green ENTER button.



5. Press 1 on the keypad to select “**States**” and then press the green ENTER button.



6. Press 2 on the key pad and select “**Vims**” & then press the green ENTER button.



7. Repeat step 6



Steps 8 – 13 the R & AV numerical numbers must change when the desired function is activated.

8. Select “**Motion**” then press the Green enter button.

Lift Link Telematics Installation

Logisnext



9. Press the throttle in the fwd or rev travel direction. Verify that the **R & AV** numerical values change. Perform this step for both fwd & rev throttle. Confirm **R & AV** values change press Red ESC button.



10. Toggle down to "**LIFT**" and press the GREEN enter button.



11. Press the up button and verify that the **R & AV** numerical numbers change. Confirm the R & AV numbers change & then press the Red ESC button.



11. Press the up button and verify that the **R & AV** numerical numbers change. Confirm the R & AV numbers change & then press the Red ESC button.



12. Toggle down to "**SEAT**" and press the GREEN enter button.



13. Depress the seat or step on the operator presence switch & verify the **R & AV** numerical numbers change. Confirm the **R&AV** number change & press the Red ESC button several times to return to the main start screen. You should see a key or wrench symbol.



14. Press the button with a key icon just below the green LED to log off.



15. Plug the access control plug back together and verify the truck now has travel.

Plug must be plugged back in when verification is complete.

16. Verify work is complete and accurate.

Questions?

If you have any questions regarding this HPK, contact your Service Manager or Technical Communicator prior to submitting a CRM Ticket to Lift Central®.

[Open a CRM ticket](#)

© 2024 Mitsubishi Logisnext Americas Inc. All rights reserved, reproduction not permitted without written approval. CAT, CATERPILLAR, LET'S DO THE WORK, their respective logos, "Caterpillar Yellow", the "Power Edge", and Cat "Modern Hex" trade dress as well as corporate and product identity used herein, are trademarks of Caterpillar Inc., and may not be used without permission. All registered trademarks and all logos are the property of their respective owners, including Jungheinrich®. UniCarriers® is a registered trademark of Mitsubishi Logisnext Co., Ltd. ROCLA trade name, its respective wordmarks, and logos as well as corporate and product identity used herein, are trademarks of Mitsubishi Logisnext Europe Oy. Trademarks of any owner may not be used without permission.