

UNICARRIERS[®]

□ FORKLIFT □



Platinum GO4 LPG

Engine Powered Forklifts

LPG & Dual Fuel

8,000 - 11,000 lbs. Capacities | Pneumatic Tire



S P E C I F I C A T I O N S

MAIN TRUCK SPECIFICATIONS

| CHARACTERISTICS | 1 | | UniCarriers | | UniCarriers | | | |
|------------------|-----------------------|-----------------------------|--|--------------------------|-----------------------------------|------------------|-----------------------------------|--|
| | 2 | Model designation | 1 Spd / 2 Spd | PF80Y(H)LP | PF80Y(H)DF | PF90Y(H)LP | PF90Y(H)DF | |
| | 3 | Long model code | 1 Spd / 2 Spd | MJ1F4A(F)35LV | MJ1F4A(F)35DV | MJ1F4A(F)40LV | MJ1F4A(F)40DV | |
| 4 | Power Type | | | LP | Dual Fuel | LP | Dual Fuel | |
| 5 | Rated Load Capacity | | lb (kg) | 8000 (3500) | | 9000 (4000) | | |
| 6 | Load Center | Distance | in (mm) | 24 (600) | | 24 (600) | | |
| 7 | Operator Orientation | | | Sit | | Sit | | |
| DIMENSIONS | 8 | Tire Type | Front & rear | Pneumatic | | Pneumatic | | |
| | 9 | Wheels | Number - front/rear(x=driven) | 2x / 2 | | 2x / 2 | | |
| | 10 | Mast | Maximum fork height | in (mm) | 130 (3300) | 130 (3300) | | |
| | 11 | | Mast lowered (OHL) | in (mm) | 90.4 (2300) | 90.4 (2300) | | |
| | 12 | | Mast extended with LBR | in (mm) | 181.1 (4600) | 181.1 (4600) | | |
| | 13 | | Standard freelif | in (mm) | 5.1 (130) | 5.1 (130) | | |
| | 14 | Forks | Length x thickness x width | in (mm) | 48 x 2 x 6 (1220 x 50 x 150) | | 48 x 2 x 6 (1220 x 50 x 150) | |
| | 15 | Tilt Angle | Standard mast - fwd/back | degree | 6 / 12 | | 6 / 12 | |
| | 16 | Overall Dimensions | Length (to face of forks) | in (mm) | 121.8 (3095) | | 123.1 (3130) | |
| | 17 | | Height - top of OHG | in (mm) | 92.5 (2350) | | 92.5 (2350) | |
| | 18 | | Height - top of standard LBR | in (mm) | 48.0 (1220) | | 48.0 (1220) | |
| | 19 | | Width - standard carriage | in (mm) | 47.2 (1200) | | 47.2 (1200) | |
| | 20 | Overall Width | Width - single tire / single wide tire | in (mm) | 58.7 (1490) / 58.7 (1490) | | — / 58.7 (1490) | |
| | 21 | | Width - dual tire / dual wide tire | in (mm) | 69.9 (1775) / 77.6 (1975) | | 69.9 (1775) / 77.6 (1975) | |
| | 22 | Overhang | Front / rear | in (mm) | 22.0 (560) / 21.1 (535) | | 22.0 (560) / 22.4 (570) | |
| | 23 | Turning Radius | Minimum outside | in (mm) | 107.1 (2720) | | 108.3 (2755) | |
| 24 | Min Right Angle Stack | Add load length & clearance | in (mm) | 129.1 (3280) | | 130.3 (3315) | | |
| PERFORMANCE | 25 | Travel Speed Forward | Maximum* - 1st Speed / 2nd speed | mph (km/h) | 11.2 (18) / 13.7 (22) | | 11.2 (18) / 13.7 (22) | |
| | 26 | Lifting Speed | Maximum - loaded / unloaded | fpm (mm/sec) | 94.5 (480) / 94.5 (480) | | 94.5 (480) / 94.5 (480) | |
| | 27 | Lowering Speed | Maximum - loaded / unloaded | fpm (mm/sec) | 98.4 (500) / 98.4 (500) | | 98.4 (500) / 98.4 (500) | |
| | 28 | Drawbar Pull Maximum | Full load - at 1 mph | lb (N) | 6865 (30500) | | 7065 (31400) | |
| | 29 | | No load - at 1 mph | lb (N) | 5875 (26100) | | 6070 (27000) | |
| | 30 | Gradeability Maximum | Full load / no load - at 1 mph | % | 32 / 27 | | 28 / 26 | |
| WEIGHT | 31 | Truck Weight | No load - standard truck | lb (kg) | 12890 (5840) | | 13390 (6065) | |
| | 32 | Weight Distribution | Front axle - empty | lb (kg) | 5685 (2575) | | 5630 (2550) | |
| | 33 | | Rear axle - empty | lb (kg) | 7210 (3265) | | 7760 (3515) | |
| | 34 | | Front axle - with rated load | lb (kg) | 17890 (8105) | | 19580 (8870) | |
| | 35 | | Rear axle - with rated load | lb (kg) | 2725 (1235) | | 2635 (1195) | |
| CHASSIS & WHEELS | 36 | Wheelbase | | in (mm) | 78.5 (2000) | | 78.5 (2000) | |
| | 37 | Tire Size | Front Tread - single / single wide | | 8.25 x 15-14PR / 300 x 15-18PR | | — / 300 x 15-18PR | |
| | 38 | | Front Tread - dual / dual wide | | 7.50 x 16-12PR / 8.25 x 15-12PR | | 7.50 x 16-12PR / 8.25 x 15-12PR | |
| | 39 | | Rear Tread | | 7.00 x 12-12PR | | 7.00 x 12-12PR | |
| | 40 | Tread - Center of Tire | Front Tread - single / single wide | in (mm) | 49.2 (1250) / 46.5 (1180) | | — / 46.5 (1180) | |
| | 41 | | Front Tread - dual / dual wide | in (mm) | 51.5 (1310) / 56.9 (1445) | | 51.5 (1310) / 56.9 (1445) | |
| | 42 | | Rear Tread | in (mm) | 46.5 (1180) | | 46.5 (1180) | |
| | 43 | Seat Height | | in (mm) | 46.0 (1170) | | 46.0 (1170) | |
| | 44 | Headroom | SIP to bottom of OHG | in (mm) | 40 (1015) | | 40 (1015) | |
| | 45 | Counterweight Height | | in (mm) | 50.2 (1275) | | 50.2 (1275) | |
| | 46 | Step Height | | in (mm) | 18.7 (475) | | 18.7 (475) | |
| | 47 | Floor Height | | in (mm) | 31.3 (795) | | 31.3 (795) | |
| | 48 | Ground Clearance | Under mast / power unit / frame | in (mm) | 5.7 (145) / 6.7 (170) / 8.9 (225) | | 5.7 (145) / 6.7 (170) / 8.9 (225) | |
| | 49 | Service Brake | Type | | Foot, Hydraulic Boost | | Foot, Hydraulic Boost | |
| 50 | Parking Brake | Type | | Hand, Mechanical | | Hand, Mechanical | | |
| DRIVE LINE | 51 | Steering | Type | | Hydrostatic, Power | | Hydrostatic, Power | |
| | 52 | Engine | Model | | GCT TB45 | | GCT TB45 | |
| | 53 | Rated Output | SAE gross - LP, Diesel | hp(kW)@rpm | 85.7 (63.9) @ 2450 | | 85.7 (63.9) @ 2450 | |
| | 54 | Rated Torque | SAE gross - LP, Diesel | ft-lb(Nm)@rpm | 212 (288) @ 1600 | | 212 (288) @ 1600 | |
| | 55 | Displacement | | cu in (cm ³) | 273 (4478) | | 273 (4478) | |
| | 56 | Transmission Speeds | Powershift type | | 1 forward / 1 reverse | | 1 forward / 1 reverse | |
| | 57 | | Automatic type | | 2 forward / 1 reverse | | 2 forward / 1 reverse | |

* Travel speeds are the same for loaded and unloaded conditions.

MAIN TRUCK SPECIFICATIONS

| CHARACTERISTICS | 1 | Manufacturer's Name | | UniCarriers | | UniCarriers | | |
|------------------|----------------|------------------------|------------------------------------|--------------------------|-----------------------------------|-----------------------|-----------------------------------|----------------|
| | 2 | Model | Model designation | 1 Spd / 2 Spd | PF100Y(H)LP | PF100Y(H)DF | PF110Y(H)LP | PF110Y(H)DF |
| | 3 | | Long model code | 1 Spd / 2 Spd | MJ1F4A(F)45LV | MJ1F4A(F)45DV | MJG1F4A(F)50LV | MJG1F4A(F)50DV |
| | 4 | Power Type | | | LP | Dual Fuel | LP | Dual Fuel |
| | 5 | Rated Load Capacity | | lb (kg) | 10000 (4500) | | 11000 (5000) | |
| | 6 | Load Center | Distance | in (mm) | 24 (600) | | 24 (600) | |
| | 7 | Operator Orientation | | | Sit | | Sit | |
| DIMENSIONS | 8 | Tire Type | Front & rear | | Pneumatic | | Pneumatic | |
| | 9 | Wheels | Number - front/rear(x=driven) | | 2x / 2 | | 2x / 2 | |
| | 10 | Mast | Maximum fork height | in (mm) | 130 (3300) | | 130 (3300) | |
| | 11 | | Mast lowered (OHL) | in (mm) | 90.4 (2300) | | 90.4 (2300) | |
| | 12 | | Mast extended with LBR | in (mm) | 181.1 (4600) | | 181.1 (4600) | |
| | 13 | | Standard freelif | in (mm) | 6.9 (175) | | 6.9 (175) | |
| | 14 | Forks | Length x thickness x width | in (mm) | 48 x 2 x 6 (1220 x 50 x 150) | | 48 x 2 x 6 (1220 x 50 x 150) | |
| | 15 | Tilt Angle | Standard mast - fwd/back | degree | 6 / 12 | | 6 / 12 | |
| | 16 | Overall Dimensions | Length (to face of forks) | in (mm) | 126.4 (3210) | | 131.5 (3340) | |
| | 17 | | Height - top of OHG | in (mm) | 92.5 (2350) | | 92.5 (2350) | |
| | 18 | | Height - top of standard LBR | in (mm) | 48.0 (1220) | | 48.0 (1220) | |
| | 19 | | Width - standard carriage | in (mm) | 47.2 (1200) | | 47.2 (1200) | |
| | 20 | Overall Width | Width - single wide tire | in (mm) | 58.7 (1490) | | 58.7 (1490) | |
| | 21 | | Width - dual tire / dual wide tire | in (mm) | 69.9 (1775) / 77.6 (1975) | | 69.9 (1775) / 77.6 (1975) | |
| | 22 | Overhang | Front / rear | in (mm) | 23.1 (587) / 24.5 (622) | | 23.5 (597) / 23.3 (593) | |
| | 23 | Turning Radius | Minimum outside | in (mm) | 110.2 (2800) | | 115.6 (2940) | |
| | 24 | Min Right Angle Stack | Add load length & clearance | in (mm) | 133.3 (3387) | | 139.1 (3537) | |
| PERFORMANCE | 25 | Travel Speed Forward | Maximum* - 1st Speed / 2nd speed | mph (km/h) | 11.2 (18) / 13.7 (22) | | 11.2 (18) / 13.7 (22) | |
| | 26 | Lifting Speed | Maximum - loaded / unloaded | fpm (mm/sec) | 82.7 (420) / 82.7 (420) | | 82.7 (420) / 82.7 (420) | |
| | 27 | Lowering Speed | Maximum - loaded / unloaded | fpm (mm/sec) | 88.6 (450) / 88.6 (450) | | 88.6 (450) / 88.6 (450) | |
| | 28 | Drawbar Pull Maximum | Full load - at 1 mph | lb (N) | 7260 (32300) | | 7470 (33200) | |
| | 29 | | No load - at 1 mph | lb (N) | 6280 (27900) | | 6480 (28800) | |
| | 30 | Gradeability Maximum | Full load / no load - at 1 mph | % | 25 / 24 | | 23 / 22 | |
| WEIGHT | 31 | Truck Weight | No load - standard truck | lb (kg) | 15185 (6880) | | 16300 (7385) | |
| | 32 | Weight Distribution | Front axle - empty | lb (kg) | 6115 (2770) | | 6745 (3055) | |
| | 33 | | Rear axle - empty | lb (kg) | 9070 (4110) | | 9560 (4330) | |
| | 34 | | Front axle - with rated load | lb (kg) | 21940 (9940) | | 23920 (10835) | |
| | 35 | | Rear axle - with rated load | lb (kg) | 3180 (1440) | | 3420 (1550) | |
| CHASSIS & WHEELS | 36 | Wheelbase | | in (mm) | 78.5 (2000) | | 84.5 (2150) | |
| | 37 | Tire Size | Front Tread - single wide | | 300 x 15-18PR | | 300 x 15-18PR | |
| | 38 | | Front Tread - dual / dual wide | | 7.50 x 16-12PR / 8.25 x 15-12PR | | 7.50 x 16-12PR / 8.25 x 15-12PR | |
| | 39 | | Rear Tread | | 7.00 x 12-16PR | | 7.00 x 12-16PR | |
| | 40 | Tread - Center of Tire | Front Tread - single wide | in (mm) | 46.5 (1180) | | 46.5 (1180) | |
| | 41 | | Front Tread - dual / dual wide | in (mm) | 51.5 (1310) / 56.9 (1445) | | 51.5 (1310) / 56.9 (1445) | |
| | 42 | | Rear Tread | in (mm) | 46.5 (1180) | | 46.5 (1180) | |
| | 43 | Seat Height | | in (mm) | 46.0 (1170) | | 46.0 (1170) | |
| | 44 | Headroom | SIP to bottom of OHG | in (mm) | 40 (1015) | | 40 (1015) | |
| | 45 | Counterweight Height | | in (mm) | 50.2 (1275) | | 50.2 (1275) | |
| | 46 | Step Height | | in (mm) | 18.7 (475) | | 18.7 (475) | |
| | 47 | Floor Height | | in (mm) | 31.3 (795) | | 31.3 (795) | |
| | 48 | Ground Clearance | Under mast / power unit / frame | in (mm) | 5.7 (145) / 6.7 (170) / 8.9 (225) | | 5.7 (145) / 6.7 (170) / 8.9 (225) | |
| | 49 | Service Brake | Type | | Foot, Hydraulic Boost | | Foot, Hydraulic Boost | |
| | 50 | Parking Brake | Type | | Hand, Mechanical | | Hand, Mechanical | |
| DRIVE LINE | 51 | Steering | Type | | Hydrostatic, Power | | Hydrostatic, Power | |
| | 52 | Engine | Model | | GCT TB45 | | GCT TB45 | |
| | 53 | Rated Output | SAE gross - LP, Diesel | hp(kW)@rpm | 85.7 (63.9) @ 2450 | | 85.7 (63.9) @ 2450 | |
| | 54 | Rated Torque | SAE gross - LP, Diesel | ft-lb(Nm)@rpm | 212 (288) @ 1600 | | 212 (288) @ 1600 | |
| | 55 | Displacement | | cu in (cm ³) | 273 (4478) | | 273 (4478) | |
| | 56 | Transmission Speeds | Powershift type | | 1 forward / 1 reverse | | 1 forward / 1 reverse | |
| 57 | Automatic type | | | 2 forward / 1 reverse | | 2 forward / 1 reverse | | |

* Travel speeds are the same for loaded and unloaded conditions.

DIMENSIONS

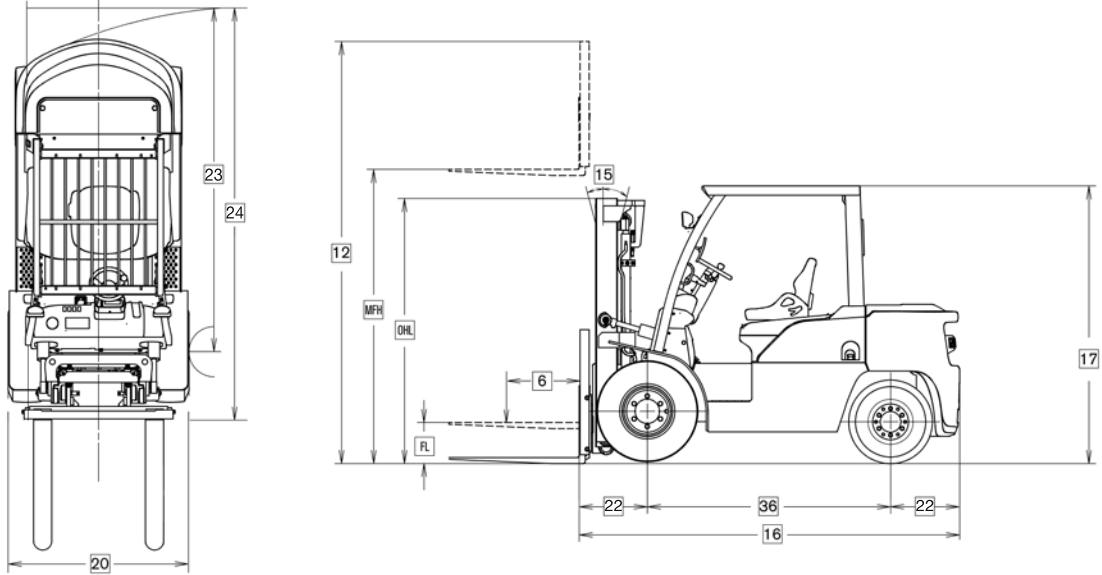

MAST SPECIFICATIONS & RATED CAPACITIES

| Mast Type | Mast Name | Maximum Fork Height | Overall Height | | | | Free Lift | | Tilt Angle | Rated Capacity at 24 in (600mm) Load Center | | | |
|----------------------------|------------|---------------------|----------------|----------------|--------------|-------------|-------------|-------------|-------------|---|--------------|-------------|--------------|
| | | | Lowered | Fully Extended | | With LBR | Without LBR | Fwd/Bkwd | | PF80Y | | PF90Y | |
| | | | | in (mm) | in (mm) | | | | With LBR | Without LBR | Single Drive | Dual Drive | Single Drive |
| TWO STAGE (Wide view) | 2W300 | 118 (3000) | 84.4 (2150) | 169.3 (4300) | 151.0 (3835) | 5.1 (130) | 5.1 (130) | 6/12 | 8000 (3500) | 8000 (3500) | 9000 (4000) | 9000 (4000) | |
| | 2W30 | 130 (3300) | 90.4 (2300) | 181.1 (4600) | 162.8 (4135) | 5.1 (130) | 5.1 (130) | 6/12 | 8000 (3500) | 8000 (3500) | 9000 (4000) | 9000 (4000) | |
| | 2W350 | 138 (3500) | 95.7 (2435) | 189.0 (4800) | 170.7 (4335) | 5.1 (130) | 5.1 (130) | 6/12 | 8000 (3500) | 8000 (3500) | 9000 (4000) | 9000 (4000) | |
| | 2W370 | 146 (3700) | 100.2 (2550) | 196.9 (5005) | 178.5 (4535) | 5.1 (130) | 5.1 (130) | 6/12 | 8000 (3500) | 8000 (3500) | 9000 (4000) | 9000 (4000) | |
| | 2W400 | 157 (4000) | 108.1 (2750) | 208.7 (5300) | 190.4 (4835) | 5.1 (130) | 5.1 (130) | 6/12 | 8000 (3500) | 8000 (3500) | 9000 (4000) | 9000 (4000) | |
| | 2W450 | 177 (4500) | 117.9 (3000) | 228.3 (5800) | 210.0 (5335) | 5.1 (130) | 5.1 (130) | 6/6 | 8000 (3500) | 8000 (3500) | 9000 (4000) | 9000 (4000) | |
| THREE STAGE (Full free) | 2W500 | 197 (5000) | 127.8 (3250) | 248.0 (6300) | 229.7 (5835) | 5.1 (130) | 5.1 (130) | 6/6 | 8000 (3500) | 8000 (3500) | 9000 (4000) | 9000 (4000) | |
| | 3F385 | 152 (3850) | 78.5 (2000) | 202.8 (5055) | 186.0 (4725) | 29.5 (750) | 46.3 (1175) | 6/6 | 8000 (3500) | 8000 (3500) | 9000 (4000) | 9000 (4000) | |
| | 3F430 | 169 (4300) | 84.4 (2150) | 220.5 (5600) | 203.7 (4175) | 35.4 (900) | 52.2 (1325) | 6/6 | 8000 (3500) | 8000 (3500) | 9000 (4000) | 9000 (4000) | |
| | 3F475 | 187 (4750) | 90.4 (2300) | 238.2 (6050) | 221.5 (5625) | 41.3 (1050) | 58.1 (1475) | 6/6 | 8000 (3500) | 8000 (3500) | 9000 (4000) | 9000 (4000) | |
| | 3F515 | 203 (5150) | 95.7 (2435) | 253.9 (6450) | 237.2 (6025) | 46.7 (1185) | 63.4 (1610) | 6/6 | 7800 (3400) | 8000 (3500) | 8700 (3850) | 8700 (3850) | |
| | 3F550 | 217 (5500) | 100.2 (2550) | 267.7 (6800) | 251.0 (6375) | 51.2 (1300) | 67.9 (1725) | 6/6 | 5300 (2300) | 7600 (3300) | 6900 (3050) | 8500 (3750) | |
| 3F600 | 236 (6000) | 108.1 (2750) | 287.4 (7300) | 270.7 (6875) | 59.1 (1500) | 75.8 (1925) | 6/6 | 4000 (1750) | 7200 (3150) | 5200 (2300) | 8300 (3650) | | |

MAST SPECIFICATIONS & RATED CAPACITIES

| Mast Type | Mast Name | Maximum Fork Height | Overall Height | | | | Free Lift | | Tilt Angle | Rated Capacity at 24 in (600mm) Load Center | | | |
|----------------------------|------------|---------------------|----------------|----------------|--------------|-------------|-------------|-------------|--------------|---|--------------|--------------|--------------|
| | | | Lowered | Fully Extended | | With LBR | Without LBR | Fwd/Bkwd | | PF100Y | | PF110Y | |
| | | | | in (mm) | in (mm) | | | | With LBR | Without LBR* | Single Drive | Dual Drive | Single Drive |
| TWO STAGE (Wide view) | 2W300 | 118 (3000) | 84.4 (2150) | 169.3 (4300) | 153.0 (3890) | 6.9 (175) | 6.9 (175) | 6/12 | 10000 (4500) | 10000 (4500) | 11000 (5000) | 11000 (5000) | |
| | 2W330 | 130 (3300) | 90.4 (2300) | 181.1 (4600) | 164.8 (4185) | 6.9 (175) | 6.9 (175) | 6/12 | 10000 (4500) | 10000 (4500) | 11000 (5000) | 11000 (5000) | |
| | 2W350 | 138 (3500) | 95.7 (2435) | 189.0 (4800) | 172.6 (4385) | 6.9 (175) | 6.9 (175) | 6/12 | 10000 (4500) | 10000 (4500) | 11000 (5000) | 11000 (5000) | |
| | 2W370 | 146 (3700) | 100.2 (2550) | 196.9 (5005) | 180.5 (4585) | 6.9 (175) | 6.9 (175) | 6/12 | 10000 (4500) | 10000 (4500) | 11000 (5000) | 11000 (5000) | |
| | 2W400 | 157 (4000) | 108.1 (2750) | 208.7 (5300) | 192.3 (4885) | 6.9 (175) | 6.9 (175) | 6/12 | 10000 (4500) | 10000 (4500) | 11000 (5000) | 11000 (5000) | |
| | 2W450 | 177 (4500) | 117.9 (3000) | 228.3 (5800) | 212.0 (5385) | 6.9 (175) | 6.9 (175) | 6/6 | 10000 (4500) | 10000 (4500) | 11000 (5000) | 11000 (5000) | |
| THREE STAGE (Full free) | 2W500 | 197 (5000) | 127.8 (3250) | 248.0 (6300) | 231.7 (5885) | 6.9 (175) | 6.9 (175) | 6/6 | 10000 (4500) | 10000 (4500) | 11000 (5000) | 11000 (5000) | |
| | 3F385 | 152 (3850) | 84.4 (2150) | 202.8 (5150) | 186.4 (4735) | 35.6 (905) | 52.0 (1320) | 6/6 | 10000 (4500) | 10000 (4500) | 11000 (5000) | 11000 (5000) | |
| | 3F430 | 169 (4300) | 90.4 (2300) | 220.5 (5600) | 204.1 (5185) | 41.5 (1055) | 57.9 (1470) | 6/6 | 10000 (4500) | 10000 (4500) | 11000 (5000) | 11000 (5000) | |
| | 3F475 | 187 (4750) | 95.7 (2435) | 238.2 (6050) | 221.9 (5635) | 46.9 (1190) | 63.2 (1605) | 6/6 | 10000 (4500) | 10000 (4500) | 11000 (5000) | 11000 (5000) | |
| | 3F515 | 203 (5150) | 100.2 (2550) | 253.9 (6450) | 237.6 (6035) | 51.4 (1305) | 67.7 (1720) | 6/6 | 9600 (4300) | 10000 (4500) | 9800 (4450) | 11000 (5000) | |
| | 3F550 | 217 (5500) | 108.1 (2750) | 267.7 (6800) | 251.4 (6385) | 59.3 (1505) | 75.6 (1920) | 6/6 | 7000 (3150) | 9700 (4350) | 7100 (3200) | 10800 (4900) | |
| 3F600 | 236 (6000) | 117.9 (3000) | 287.4 (7300) | 271.1 (6885) | 69.1 (1755) | 85.4 (2170) | 6/6 | 5300 (2350) | 9400 (4200) | 5400 (2450) | 9600 (4350) | | |

*Overall Height - Fully Extended Without LBR, should be reduced by 1.2" to calculate PF100Y Two-Stage Masts (2W)

STANDARD EQUIPMENT

- UniCarriers' own GCT TB45 LP or dual fuel, in-line, 6-cylinder industrial engine
- Computer controlled electronic engine system, with single-port fuel injection (LP) and multi-port injection (gas*), providing low emission levels
- Engine/transmission protection and warning system
- Operator Presence System
- Full suspension seat with operator restraint system
- Horn and back-up alarm
- Cushioned floor mat
- Tilt-adjustable steering wheel
- Multi-function LCD:
 - Hour meter, Clock, Calendar & Operator PIN access
 - Onboard diagnostics and programmable service reminders
 - Warning lights & engine coolant temperature gauge
 - Air cleaner service indicator
 - Low engine oil pressure warning
 - Low coolant & brake fluid level warning indicators
 - Low fuel warning indicator & fuel gauge (Gasoline)
- Single speed powershift transmission with full floating powertrain
- Hydrostatic power steering
- Hydraulic boosted brakes
- Single lift/tilt hydraulic control lever
- High air intake system with large 7" cyclone air filter
- Overhead guard mounted LED headlights
- 5-piece reinforced overhead guard

OPTIONAL EQUIPMENT

- High/Low travel speed control settings
- Power/Economy acceleration mode
- Two speed automatic transmission
- Separate lift and tilt hydraulic control levers
- Synchronized steering with spinner knob
- Swivel seat with rear overhead guard mounted assist grip with horn button
- Solid or dual drive pneumatic tires
- Anti-Dust, Low Noise, or Corrosion Resistance packages
- Tilt cylinder boot covers
- Vertical exhaust (not available on LPS models)
- Radiator screen
- Air intake pre-cleaner
- Rear LED combination light package
- Rotating beacon or strobe light
- Rear LED work light
- Low overhead guard (88.5" high)

* on Dual Fuel Models

OPERATOR COMFORT & CONTROL

A spacious operator compartment provides generous foot, leg and head room for a variety of driver sizes. A standard full suspension seat with soft touch arm pads and back angle adjustment provides maximum operator comfort. Its low profile design offers ample head clearance, while front to back travel adjustment allows a comfortable, customized fit for nearly any operator height.

The Platinum G04's tilt-adjustable steering wheel helps the operator quickly find his or her ideal driving position, while its compact design offers enhanced control and handling. Hydrostatic power steering minimizes steer effort and operator fatigue. Hydraulic boosted brakes offer reduced pedal effort and improved brake durability. An optional swivel seat produces greater operator comfort and visibility while driving in reverse, and includes a rear assist grip with horn button to further enhance operator productivity. Automotive-style light and turn signal levers simplify repetitive actions allowing the operator to focus on the job. An optional auto tilt leveling system assists proper mast/fork positioning.

Enhanced comfort results from the Platinum G04 Series' Operator Comfort System, which includes a full suspension seat, cushion floor mat, pedals mounted to the chassis frame, and rubber shock absorbers located throughout the vehicle to reduce vibration from the engine and transmission to the operator. For additional vibration reduction, Platinum G04 Series models include an automotive-type floating powertrain design, which incorporates four rubber engine/transmission supports. The G04's chassis has been designed with a low center of gravity (CG), with the roll center of the rear axle mounted close to the CG, for enhanced stability.

The G04 features tandem hydraulic pumps, with one pump for lifting and one pump for the power steering and brake booster. A priority load sensing control valve allows the steering/brake pump to supply hydraulic oil to the lift system when not required for steering/braking.

ENHANCED WORK ENVIRONMENT

Several standard features are included in the GO4 Series to deliver a more comfortable and productive work environment for the operator and those in the surrounding area.

UniCarriers' own GCT TB45 engine offers extremely low noise levels at the operator's ear during idle and at maximum travel speeds. An optional travel speed control feature is available to regulate high or low maximum travel speed settings, while the optional controlled acceleration's Economy Mode adjusts throttle sensitivity to increase fuel efficiency, extend drivetrain life and reduce excessive tire wear. Two-speed models feature an automatic transmission with reduced shift shock due to shortened shift time lag and utilization of an optimized shift schedule.

The GO4 Series' Operator Presence System, with seat-actuated power interrupt, incorporates a mast-lock which automatically locks lift and tilt operations when the operator leaves the seat, and a return to neutral feature to minimize forklift movement if the operator leaves the seat while the lift truck is still in gear. This presence system also includes audible and visual warnings if either the seat belt is not engaged, or when the parking brake has not been applied prior to the operator exiting the compartment.

For easy entry/exit from either side, welded metal assist grips, combined with a replaceable metal traction plate bolted to the truck's wide, low entry step, provide the operator with sure, comfortable footing and grip for this often repeated task.

DURABLE DESIGN FEATURES

The G04 Series is built for rugged applications, incorporating a robust mast, strong frame, thick steel fenders, and 5-ton truck drive and steer axles across all models.

The G04's superior cooling system consists of an oversized fan and wide cooling outlet, for enhanced airflow, and a heavy-duty radiator, with transmission oil cooler, rubber mounted to reduce flexing and absorb vibration for enhanced reliability. Its improved cooling capacity translates into dependable cooling efficiency under heavy usage or high ambient temperatures. A heavy-duty steer axle, cast for improved axle strength, protects the steer cylinder from damage, while steer cylinder boot covers keep out dirt and debris. The rear axle ball joints, with dust covers for protection against dirt, include grease fittings for easy lubrication to provide longer life and steering ease.

Lift cylinders include oil return piping for reduced heat generation. The counterweight is designed to deflect cooling airflow down and away from the truck, and it features a built-in radiator protection bar.

IP55 & IP65 rated control modules, combined with a wiring harness with sealed connectors, deliver protection against dirt and corrosion.

EASE OF MAINTENANCE

Tilt cylinders can be greased without removing any body panels. One bolt removal allows the two-piece diamond tread floorboard to be lifted off, promoting simple access to hydraulic components. Detachable side panels and a wide-open clamshell hood provide a roomy area for service technicians to perform their tasks. The five-piece reinforced overhead guard simplifies replacement of individual components if necessary, saving time and money. An access door in the floor board allows for quick and easy brake fluid checks.

A multi-function LCD display includes on-board diagnostics to keep service time low, with a programmable service reminder in order to stay current with periodic maintenance needs. Its display design provides the operator with excellent visibility and understanding of indicator lights.

ELECTRONIC CONTROLLED ENGINE TECHNOLOGY

The GCT electronic fuel injected system analyzes engine performance parameters and optimizes engine operation, resulting in enhanced productivity and lower fuel consumption. This system includes three main components: Engine Control Module (ECM), Vehicle Control Module (VCM), and Multi-function LCD.

The ECM responds to sensor input to control basic engine related functions, such as proper air/fuel ratio, torque and speed, based on the requirements of the application. The VCM monitors a number of sensors to alert the operator of changing conditions via a full range of warning indicators located on the truck's LCD. All communication among these components occurs through a Controller Area Network (CAN) system.

The GCT industrial engine is specifically designed and tested for industrial applications in order to deliver high power and torque to meet the needs of the application. As an added safeguard for your investment, the G04 Series includes an engine and transmission protection and warning system to reduce engine rpm in the event of excessive heat generation or loss of engine oil.

LOW EMISSION ENGINE

UniCarriers' global commitment to preserving and protecting the environment is evident in the our own TB45 low emission, 6-cylinder LPG or dual fuel (LP & Gasoline) industrial engine, offering improved fuel consumption. The combination of advanced engine technology results in high power and increased efficiency, with emission levels well below EPA and CARB requirements.



UniCarriersAmericas.com

SS-G04-TB45 05-2018 Printed in U.S.A.

UniCarriers® is a registered trademark of UniCarriers Corporation. Platinum® is a registered trademark of UniCarriers Americas. UniCarriers Americas Corporation reserves the right to make product changes relating to colors, equipment, specifications or available options without notice. For more information, contact your UniCarriers representative.

